

Munters R-Series Rental Dehumidifiers

R-Series | 5,000, 10,000 & 15,000 SCFM

Benefits

- Rugged and longer lasting construction compared to foam panel systems
- Durable construction designed to withstand frequent movement and transportation
- 15–30% less energy consumption compared to other suppliers
- Lower dew points are achieved through Munters' 400 mm rotor
- Dual reactivation provides utility source flexibility at customer site

Munters R-Series dehumidifiers provide the rental industry with a line of reliable and durable dehumidification systems built for ease of mobility and flexibility to meet a wide variety of customer requirements and applications.

Each system contains Munters' patented Honeycombe® desiccant rotor technology and is available in sizes of 5,000 SCFM, 10,000 SCFM or 15,000 SCFM.



Munters R-Series Rental Dehumidifiers

R-Series | 5,000, 10,000 & 15,000 SCFM

Features

- Minimum 1/8" aluminum all-welded construction
- Cage is designed to bolt directly to skid with top-of-cage certified lifting lugs
- Integral forklift pockets and lifting points
- R-5,000 and R-10,000 designed to be stackable
- 400mm deep Silica Gel rotor
- Gas and electric dual reactivation
- Natural gas and propane single gas train selector switch
- Cam lock power connections
- Chain wheel drive
- Dry air fans provide 5" W.C. external static pressure at maximum volumes and higher at lower volumes
- 18"/20" round connection with tethered plastic inlet/outlet covers work as lay-flat duct holders when ducting is required
- User instructions and unit flow diagram (with red and green status lights for reactivation temp, wheel drive, process fan, etc.) located directly on units
- ETL/UL approved

Configuration

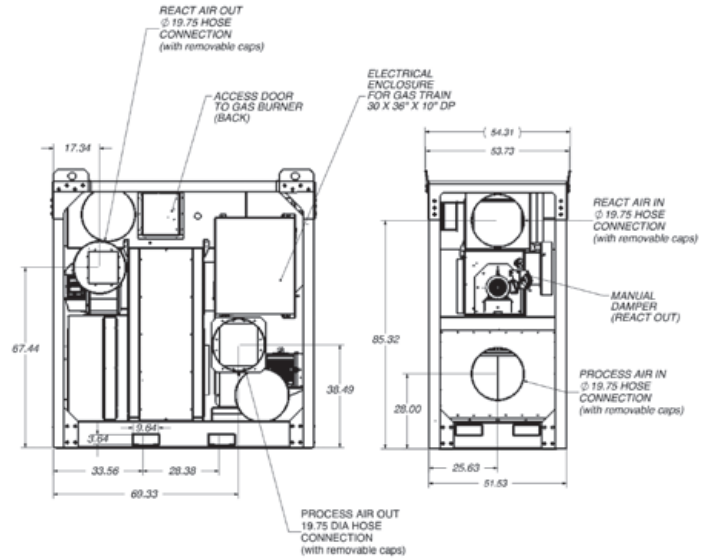

Drawing above represents R-5000 model. Configuration and design is similar for other models within this product series.

Rental units performance table

Unit	Air Flow, Nominal CFM	Moisture Removal 80°F, 60% RH (lb/hr)	Efficiency (BTUH per lb of H ₂ O removed)	Dry Air External Static Pressure	Dimensions LxWxH (in.)	Weight (lb)	Power	Power Required, Full Load Amps	Dry Air Duct Connections	Recommended Generator Size, kW (kVA)	Gas Reactivation Available
R-5,000	5,000	157	1826	5.0" ESP	99 x 54.2 x 99.3	3,600	460v/3/60	132	18" or 20"	100 kW (125)	Electric and Gas
R-10,000	10,000	330	1861	5.0" ESP	181 x 87 x 99.2	6,100	460v/3/60	282	(2) 18"/20" Returns, (2) 18"/20" Supply	225 kW (250)	Electric and Gas
R-15,000	15,000	405	1955	5.0" ESP	203.5 x 87 x 100	7,700	460v/3/60	Elec React: 338 Gas React: 77	(3) 18"/20" Returns, (3) 18"/20" Supply	303 kW (320)	Electric and Gas

Options for Munters R-(Rental) products

Round Inlet & Outlet Duct Connections: 18" or 20"

Cage: Yes or No

Power: 480v/3/60 and 575/3/60 (for Canada)

React: Optional Gas Only. Optional Electric Only.

Skid & Cage Finish: Painted steel or hot dipped galvanized

Unit Color: Gray is standard. Custom colors available.

Munters invented the desiccant rotor technology and provides its rental equipment customers with over 60 years of application, selection and energy optimization expertise and support.

Find your nearest Munters office at www.munters.com

Munters reserves the right to make alterations to specifications, quantities, etc., for production or other reasons, subsequent to publication. © Munters AB, 2021