

Quick Assembly Guide

MWI Side Wall Inlet

Parts List:

Item	Part Name/Description	QTY
1	Left Side Support	1
2	Right Side Support	1
3	Top header	1
4	Bottom header	1
5	Door, curved	1
6	Left side door, end cap	1
7	Right side Door, end cap	1
8	Gasket seal	2
9	Metal Guard	1
10	Rubber seal	1
11	L-screw hook	2

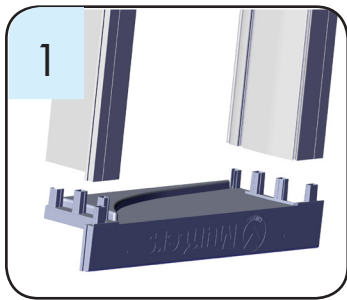
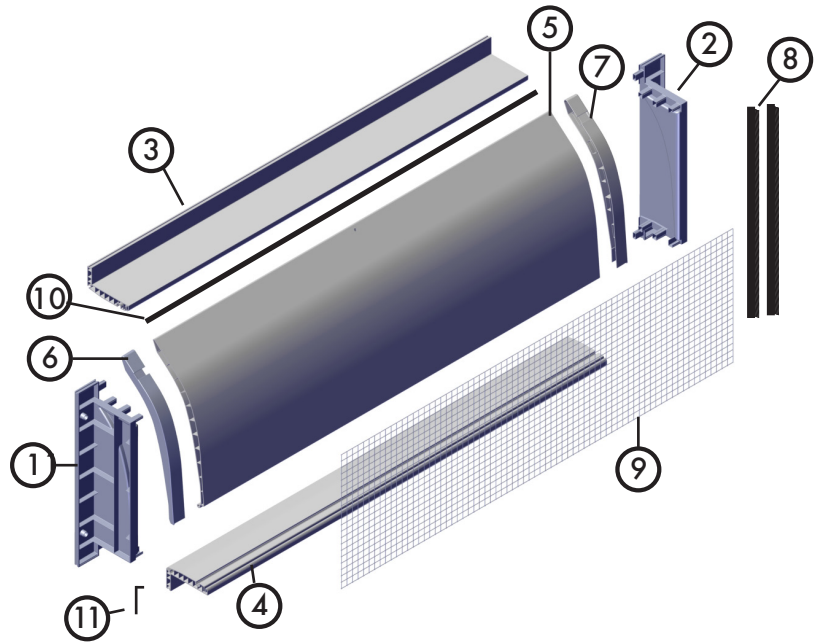

1 Insert top and bottom headers into the right-side lateral support.

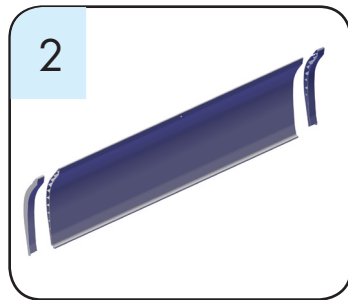

2 Insert the left and right side end caps onto the curved louver. Add seal.

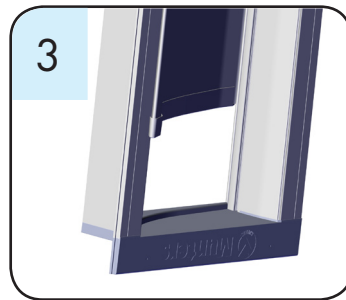

3 Slide the curved louver in the Bottom header slot

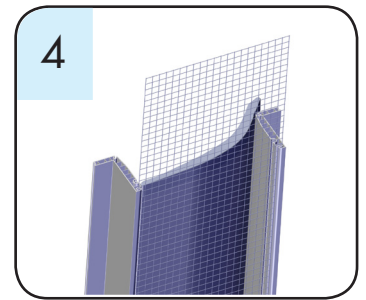

4 Slide the metal grid in the headers slot

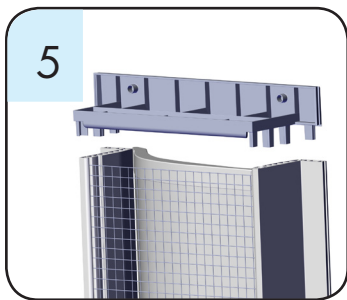

5 Slide insert the left side lateral support.

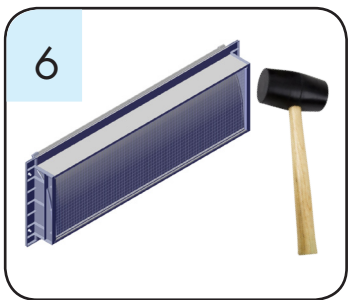

6 Properly secure the MWI lateral supports using a rubber mallet. Use caution!

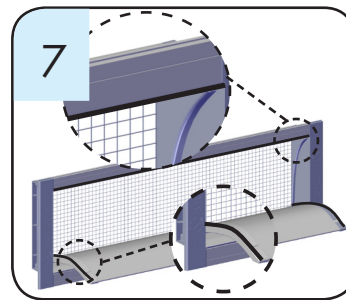

7 Insert the rubber seal in the top header slot and along door sides.

⚠ WARNING:

Do Not use metal hammer to secure the MWI. The use of a metal hammer can result in damage to MWI.

NOTE: The following guidelines should be used and closely followed when assembling and installing MWI.

In order to assure proper performance and correct functioning of the inlets, the installer must understand the importance of quality construction-work and use quality materials. Attention to details relating the assembly work, proper sealing or prevention of air leaks is a must and must be undertaken by the installer.

WARNINGS: Do not overtighten the screws! Tighten until flush. Do not dent the housing! Overtightening the screws will result in damage to MWI.

Quick Installation Guide

MWI Side Wall Inlet

Item	Inlet Size		Framed Opening Size	
	W x H x D		Should be 0.5inch or 1.2cm larger than the inlet size	
	inch	cm	inch	cm
Black MWI 4413 B	44 x 13 x 4	111.8 x 33 x 10	44.5 x 13.5	113 x 34.3
MWI 4408 B	44 x 8.25 x 4	111.8 x 21 x 10	44.5 x 8.75	113 x 22.2



1 Place the inlet into framed opening. **NOTES:** the opening size is critical! Leave always a gap of 0.2inch or 5mm evenly distributed around the unit.



2 Fasten the left and right lateral side support using appropriate screws (2-inch or 5 cm). **NOTES:** Fastening points are marked on both supports. Screws and fittings are not included, Choose screws and fittings that are suited to the material in the wall and have sufficient holding power. If uncertain, contact Munters.



3 Fasten the bottom header profile using appropriate screw. **NOTES:** Fastening should be done in the center, on the marked line. Make sure the bottom header is straight (linear) when fastening.



4 Push slightly up on the top header center, 0.25 inch or 0.6 cm. needed difference. Fasten the top header profile using appropriate screw. **NOTES:** Make sure the slight curvature of approximately 0.25 inch or 0.6 cm is achieved before fastening. Fastening should be done in the center, on the marked line.



5 Verify the correct movement, opening and closing of the inlet.



6 Fasten the (2) L-Screw hooks evenly spaced above header. Place 0.5 inch or 1.2 cm above the top header, opposite to the direction of pull. **NOTES:** Avoid interference with the pulling cable or rod.



7 Install a small pulley at the top of the inlet. **NOTES:** Pulley or fitting are not included. Choose pulleys that are suited to the type of system or wall and have sufficient holding power. If uncertain, contact Munters.

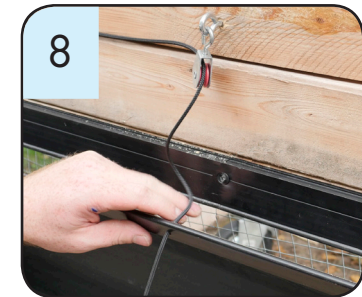

8 Pass the string through the hole in the curved louver then through the pulley, towards the direction of pulling force. Fix the string to the main pull cable or rod using clamp.

9 Caulk all sides four internal edges of the MWI after installation using a caulk gun. **NOTE:** Mounting hardware, silicone and caulk gun are not included. **WARNING:** Do not use expandable foam to seal the edges of MWI! The use of expandable foam can result in damage of MWI.

10 After the actuator & wire-ropes or rod system are installed, re-adjust all MWI properly to assure correct opening and closing.

Australia Munters Pty Limited, Phone +61 2 6025 6422, **Brazil** Munters Brasil Industria e Comercio Ltda, Phone +55 41 3317 5050, **Canada/US** Munters Corporation Mason, MI Phone +1 517 676 7070, **China** Munters Air Treatment Equipment (Beijing) Co. Ltd, Phone +86 10 80 481 121, **Denmark** Munters A/S, Phone +45 9862 3311, **India** Munters India, Phone +91 20 3052 2520, **Indonesia** Munters, Phone +62 818 739 235, **Italy** Munters Italy S.p.A., Chiusavecchia, Phone +39 0183 52 11, **Japan** Munters K.K., Phone +81 3 5970 0021, **Korea** Munters Korea Co. Ltd., Phone +82 2 761 8701, **Mexico** Munters Mexico, Phone +52 818 262 54 00, **Russia** Munters AB, Phone +7 812 448 5740, **Singapore** Munters Pte Ltd., Phone +65 744 6828, **South Africa and Sub-Sahara Countries** Munters (Pty) Ltd., Phone +27 11 997 2000, **Spain** Munters Spain S.A., Phone +34 91 640 09 02, **Sweden** Munters AB, Phone +46 8 626 63 00, **Thailand** Munters Co. Ltd., Phone +66 2 642 2670, **Turkey** Munters Form Endüstri Sistemleri A.Ş, Phone +90 322 231 1338, **USA** Munters Corporation Lansing, MI Phone +1 517 676 7070, **Vietnam** Munters Vietnam, Phone +84 8 3825 6838, **Export & Other countries** Munters Italy S.p.A., Chiusavecchia Phone +39 0183 52 11